

# TOP SHELF STORAGE – POMPANO BEACH

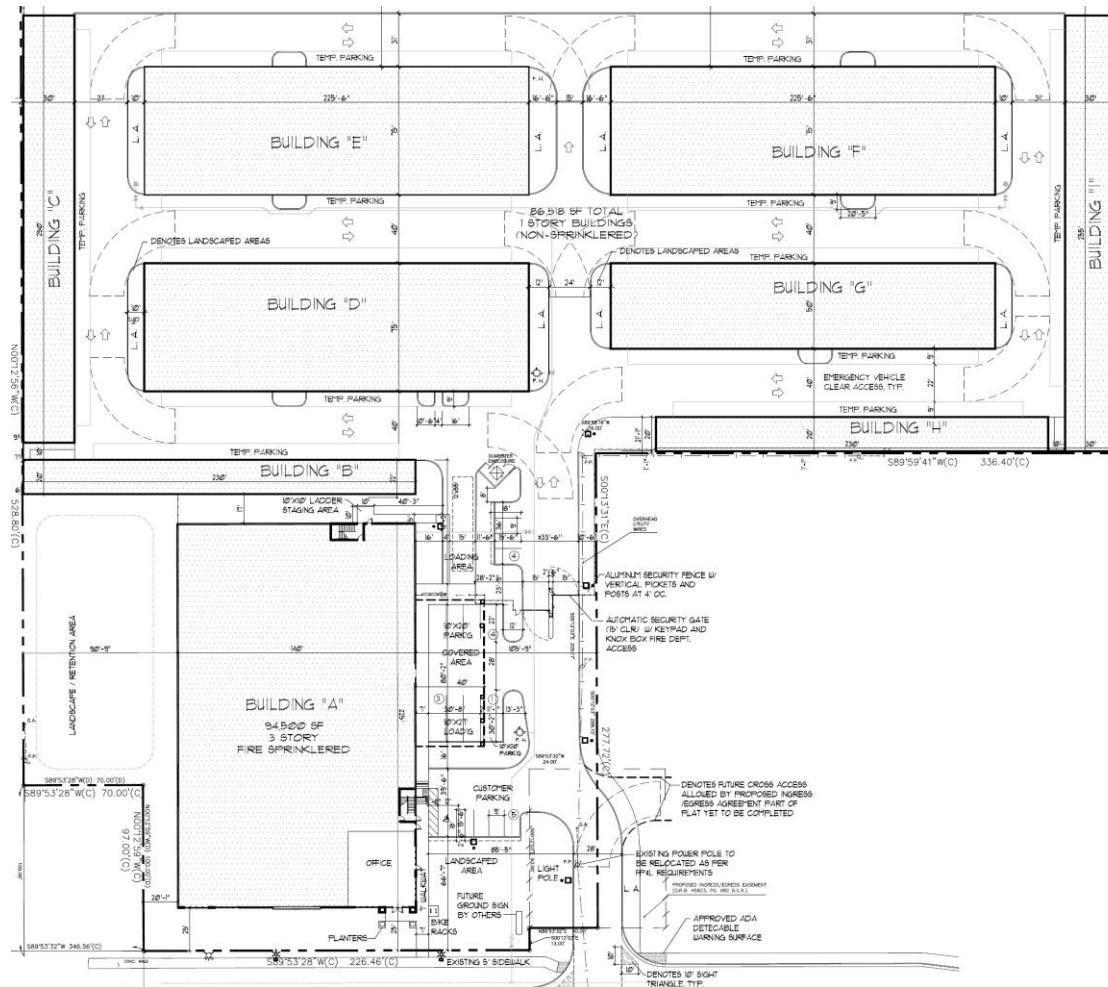

**PRELIMINARY RF SURVEY**



1521 SW 5th St  
Fort Lauderdale, FL 33312  
+1-954-607-4550  
FCC: 0021499876

**GM, CHIEF ENGINEER:**

Ric Caselli

**CLIENT:**

Perez Associates

**Top Shelf Storage**

**Project Architect:**

Frank Perez



**PROJECT LOCATION:**

2855 Martin Luther King  
Blvd., Pompano Beach Florida

**LATITUDE:**

26° 14'47.10"N

**LONGITUDE:**

80° 09'43.00"W

**ISSUE:**

11-01-2017

Cover  
Page  
**AAC**  
Page 1 of 11

PZ17-12000028  
8/3/2021

INFORMATION CONTAINED IN THIS REPORT:

(PAGE)

PROJECT LOCATION

03

TECHNICAL CRITERIA

04

ASSUMPTIONS

05

OUTDOOR SURVEY

06

BUILDING A INTERPOLATION & SURVEY

07

BUILDINGS D AND E INTERPOLATION & SURVEY

10

BUILDINGS F AND G INTERPOLATION & SURVEY

11



1521 SW 5th St  
Fort Lauderdale, FL 33312  
+1-954-607-4550  
FCC: 0021499876

**GM, CHIEF ENGINEER:**

Ric Caselli

**CLIENT:**

**Perez Associates**

**Top Shelf Storage**

**Project Architect:**

Frank Perez



**PROJECT LOCATION:**

2855 Martin Luther King  
Blvd., Pompano Beach Florida

**LATITUDE:**

26° 14'47.10"N

**LONGITUDE:**

80° 09'43.00"W

**ISSUE:**

11-01-2017

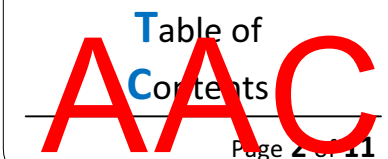

PZ17-12000028  
8/3/2021



Scale  
0 800ft



## The project's location is

2855 Martin Luther King Jr. Blvd, Pompano Beach, FL  
Latitude: 26° 14'47.10"N Longitude: 80° 09'43.00"W



1521 SW 5th St  
Fort Lauderdale, FL 33312  
+1-954-607-4550  
FCC: 0021499876

### GM, CHIEF ENGINEER:

Ric Caselli

### CLIENT:

Perez Associates

### Top Shelf Storage

### Project Architect:

Frank Perez



### PROJECT LOCATION:

2855 Martin Luther King  
Blvd., Pompano Beach Florida

### LATITUDE:

26° 14'47.10"N

### LONGITUDE:

80° 09'43.00"W

### ISSUE:

11-01-2017



Page 3 of 11

PZ17-12000028  
8/3/2021

# Technical Criteria

## Frequencies Considered

The readings were collected with a Anritsu Spectrum Analyzer model S412E. Frequency considered was in the 800 MHz SMR spectrum in the Broward County Public Safety Radio System.

## Surveys

Pre-implementation survey was conducted in 10-26-2017 and reported reliable outdoor signal at site for the Broward County Public Safety Radio System. Control channel used to obtain the readings was 857.1875 MHz. The data was collected within the area perimeter and then interpolated to the building plans using iBwave software with the assumptions described in page 4.

## Compliance

Public Safety compliance level for the Indoor interpolation maps is -95 dBm obtaining a 90% coverage throughout building.



1521 SW 5th St  
Fort Lauderdale, FL 33312  
+1-954-607-4550  
FCC: 0021499876

### GM, CHIEF ENGINEER:

Ric Caselli

### CLIENT:

Perez Associates

Top Shelf Storage

### Project Architect:

Frank Perez



### PROJECT LOCATION:

2855 Martin Luther King  
Blvd., Pompano Beach Florida

### LATITUDE:

26° 14'47.10"N

### LONGITUDE:

80° 09'43.00"W

### ISSUE:

11-01-2017

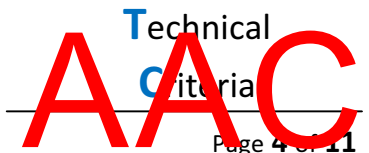



## Assumptions

Please note, this survey interpolation is based on the following assumptions:

### Building A

- Glass are low E-glass.
- Outdoor vertical walls are heavy concrete.
- Indoor walls for the units are metal and have 1 ft. less height than the actual floor. Indoor walls for office are drywall.
- Units ceiling are metal mesh that not interfere with the signal propagation.
- Stairwells and elevators are assumed as heavy concrete.
- Horizontal surfaces are heavy concrete.
- Due to storage units not being depicted in the drawings, the size and location of units and corridors were estimated.

### Buildings D, E, F, G

- Outdoor and indoor walls are metal.
- Corridors are open
- Units ceiling are metal mesh that not interfere with the signal propagation.

### Buildings B,C,H, I

- Buildings weren't part of the survey interpolation because they are composed by individual units and doors with no indoor corridors.



1521 SW 5th St  
Fort Lauderdale, FL 33312  
+1-954-607-4550  
FCC: 0021499876

#### GM, CHIEF ENGINEER:

Ric Caselli

#### CLIENT:

Perez Associates

#### Top Shelf Storage

#### Project Architect:

Frank Perez



#### PROJECT LOCATION:

2855 Martin Luther King  
Blvd., Pompano Beach Florida

#### LATITUDE:

26° 14'47.10"N

#### LONGITUDE:

80° 09'43.00"W

#### ISSUE:

11-01-2017

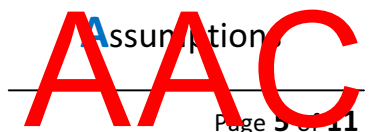

## SURVEY AND INTERPOLATION – OUTDOOR – BROWARD COUNTY SYSTEM

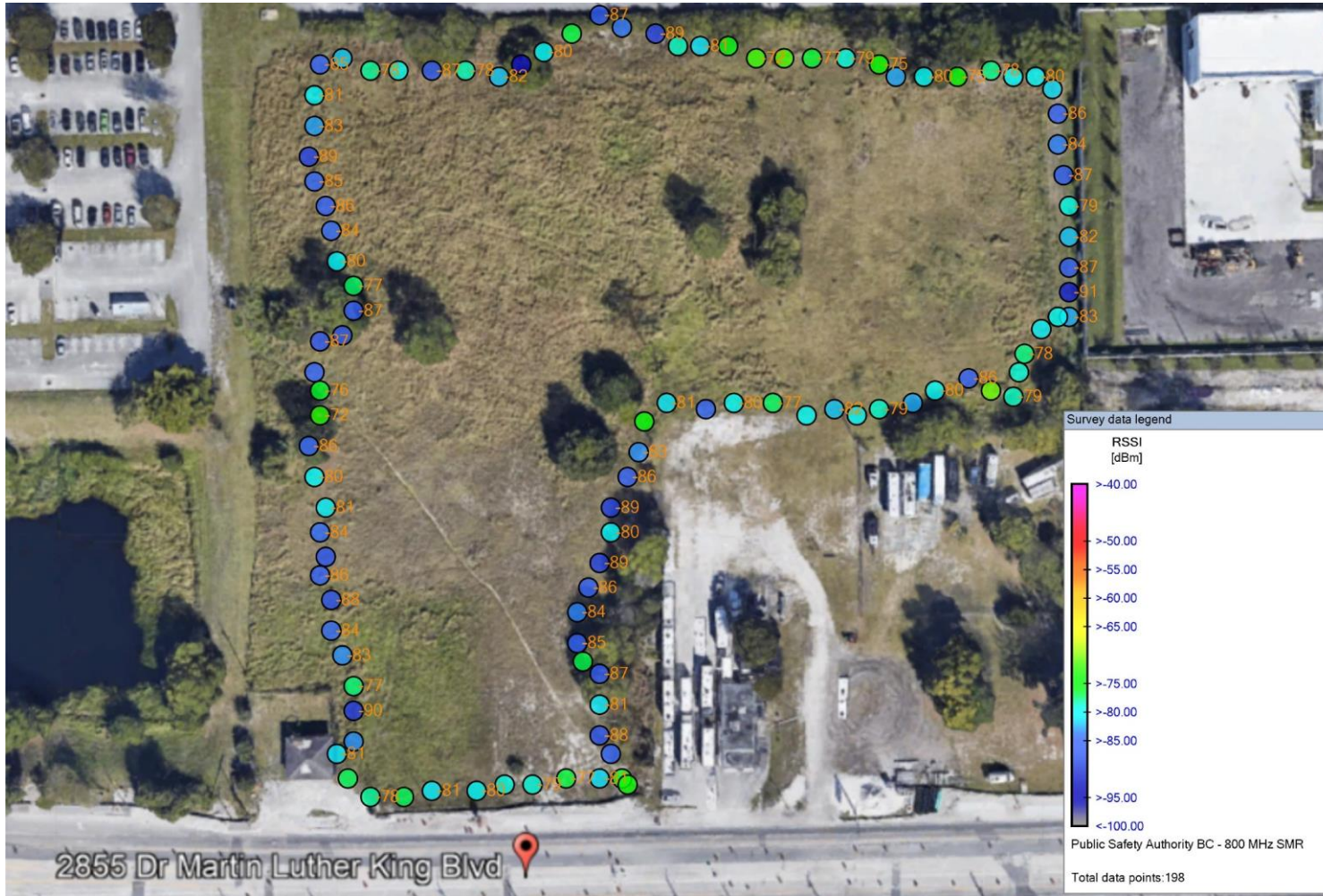

0 Scale 350ft

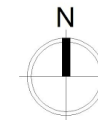

1521 SW 5th St  
Fort Lauderdale, FL 33312  
+1-954-607-4550  
FCC: 0021499876

### GM, CHIEF ENGINEER:

Ric Caselli

### CLIENT:

Perez Associates

### Top Shelf Storage

### Project Architect:

Frank Perez



### PROJECT LOCATION:

2855 Martin Luther King  
Bld., Pompano Beach Florida

### LATITUDE:

26° 14'47.10"N

### LONGITUDE:

80° 09'43.00"W

### ISSUE:

11-01-2017

**AAC** Survey  
Page 6 of 11

PZ17-12000028  
8/3/2021

## SURVEY AND INTERPOLATION – BUILDING A LEVEL 01

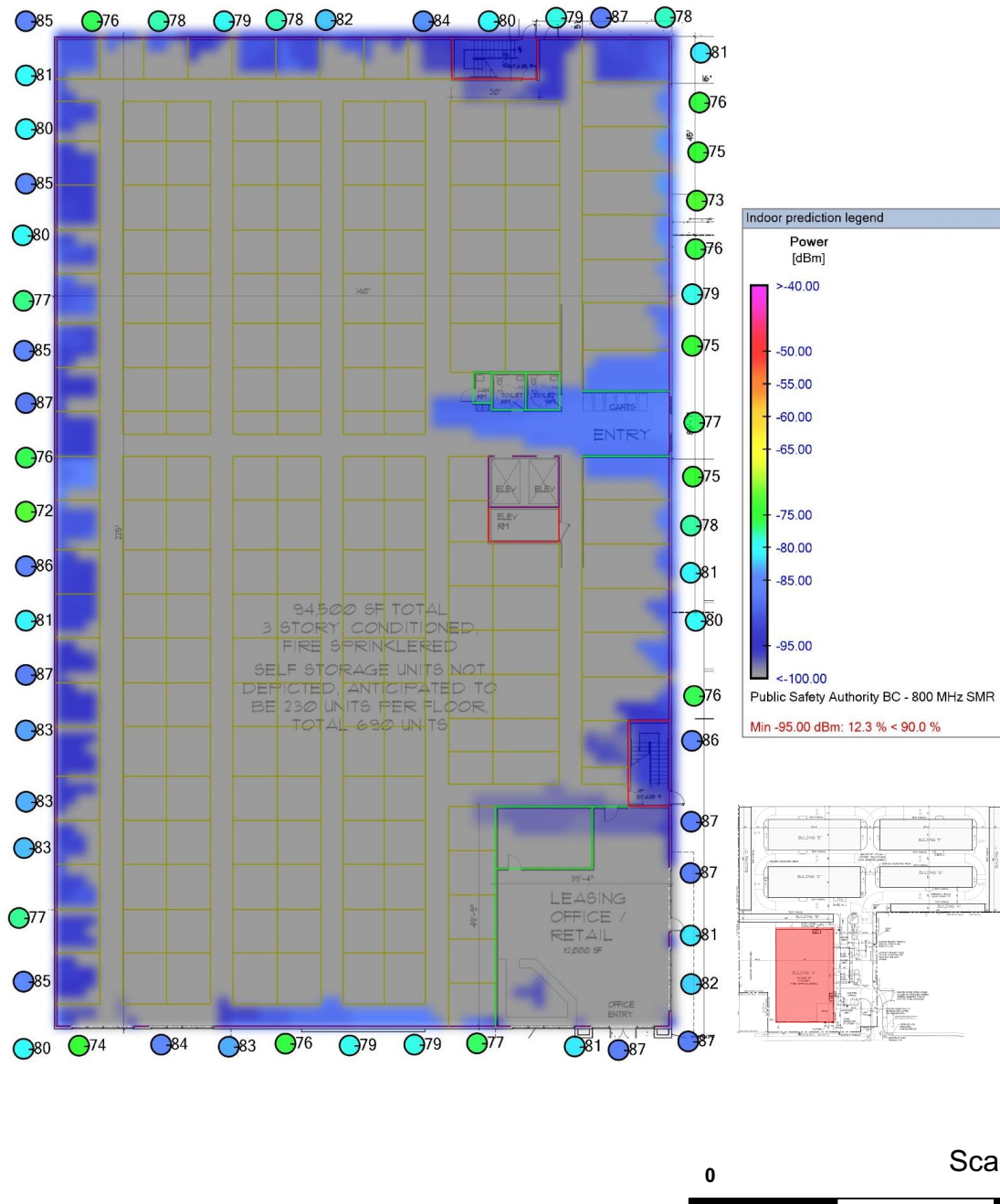

The interpolation indicates that the signal from outside penetrates the outdoor walls but there is no propagation at most corridors and elevators because of all metal in the building. Stairs have marginal coverage.

These assumptions will need to be confirmed after the construction in a preliminary indoor survey.



1521 SW 5th St  
Fort Lauderdale, FL 33312  
+1-954-607-4550  
FCC: 0021499876

### GM, CHIEF ENGINEER:

Ric Caselli

### CLIENT:

Perez Associates

Top Shelf Storage

### Project Architect:

Frank Perez



### PROJECT LOCATION:

2855 Martin Luther King  
Blvd., Pompano Beach Florida

### LATITUDE:

26° 14'47.10"N

### LONGITUDE:

80° 09'43.00"W

### ISSUE:

11-01-2017

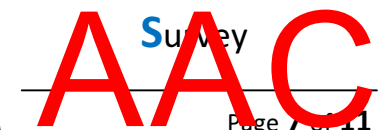

PZ17-12000028  
8/3/2021



## SURVEY AND INTERPOLATION – BUILDING A LEVEL 02

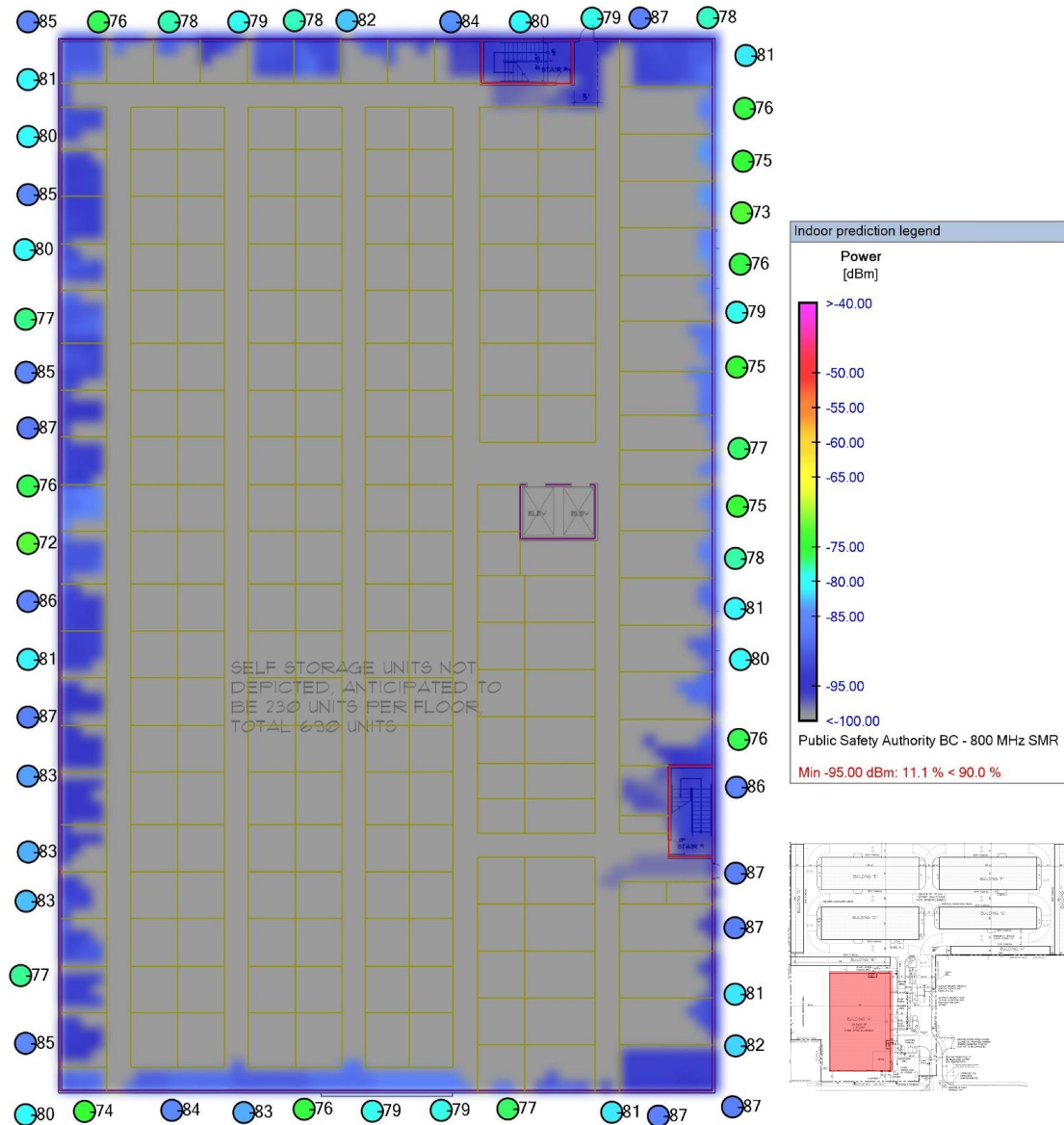

The interpolation indicates that the signal from outside penetrates the outdoor walls but there is no propagation at most corridors and elevators because of all metal in the building. Stairs have marginal coverage.

These assumptions will need to be confirmed after the construction in a preliminary indoor survey.



1521 SW 5th St  
Fort Lauderdale, FL 33312  
+1-954-607-4550  
FCC: 0021499876

### GM, CHIEF ENGINEER:

Ric Caselli

### CLIENT:

Perez Associates

Top Shelf Storage

### Project Architect:

Frank Perez



### PROJECT LOCATION:

2855 Martin Luther King  
Blvd., Pompano Beach Florida

### LATITUDE:

26° 14'47.10"N

### LONGITUDE:

80° 09'43.00"W

### ISSUE:

11-01-2017

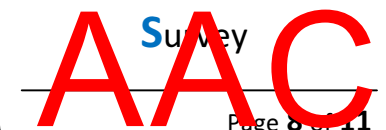

PZ17-12000028  
8/3/2021



## SURVEY AND INTERPOLATION – BUILDING A LEVEL 03

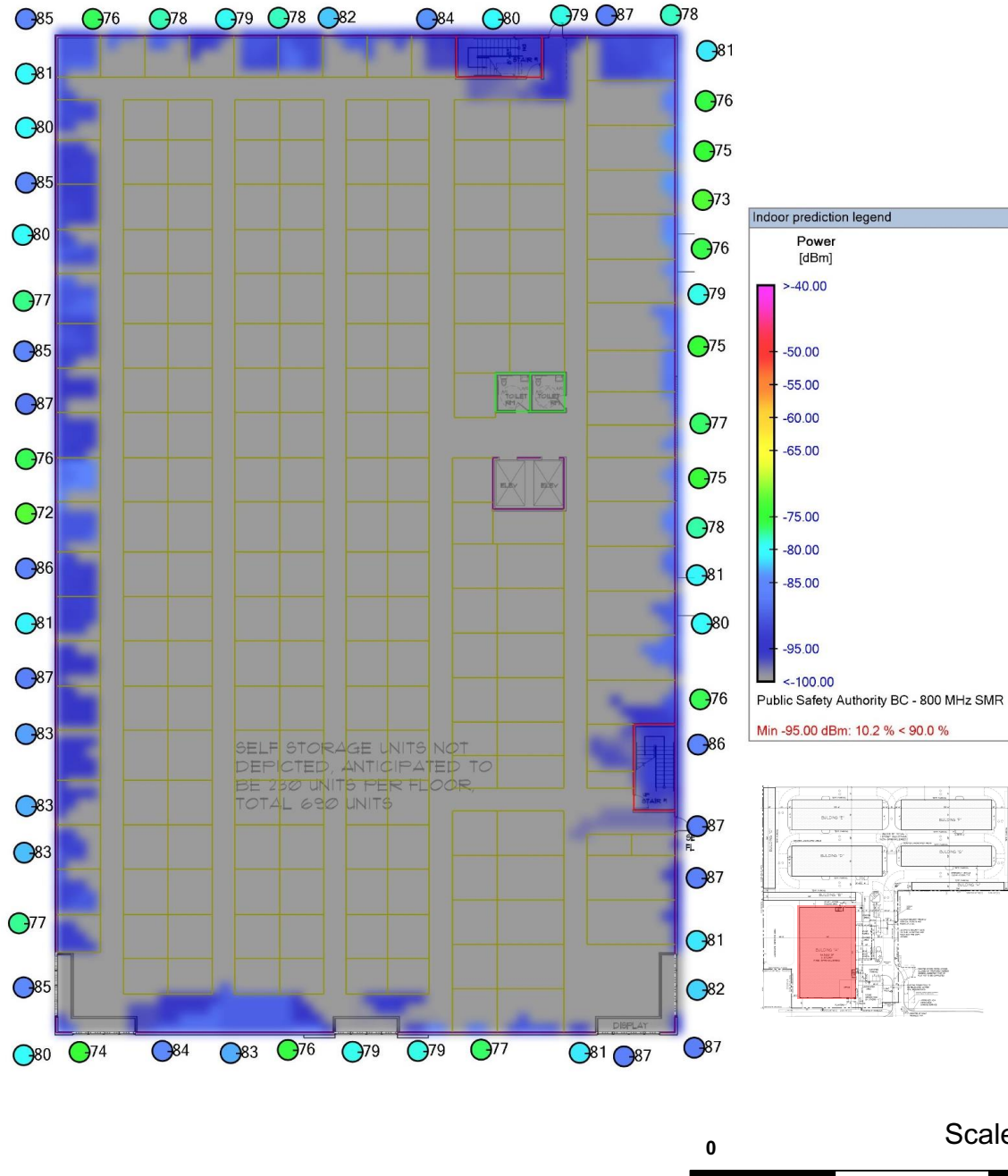

The interpolation indicates that the signal from outside penetrates the outdoor walls but there is no propagation at most corridors and elevators because of all metal in the building. Stairs have marginal coverage.

These assumptions will need to be confirmed after the construction in a preliminary indoor survey.



1521 SW 5th St  
Fort Lauderdale, FL 33312  
+1-954-607-4550  
FCC: 0021499876

### GM, CHIEF ENGINEER:

Ric Caselli

### CLIENT:

Perez Associates

Top Shelf Storage

### Project Architect:

Frank Perez



### PROJECT LOCATION:

2855 Martin Luther King Blvd., Pompano Beach Florida

### LATITUDE:

26° 14'47.10"N

### LONGITUDE:

80° 09'43.00"W

### ISSUE:

11-01-2017

AAC Survey

Page 9 of 11

PZ17-12000028  
8/3/2021

## SURVEY AND INTERPOLATION – BUILDING E LEVEL 01

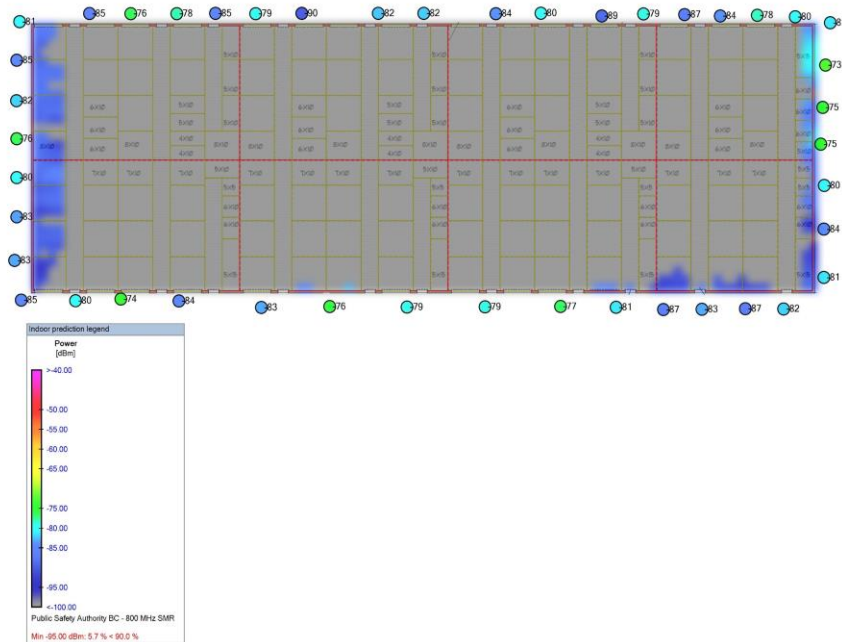

The interpolation indicates that the signal from outside penetrates some of the outdoor walls but there is no propagation at most corridors because of all metal in the building. Since this building has open corridors, it's up to the AHJ to require or not a system to achieve coverage.

These assumptions will need to be confirmed after the construction in a preliminary indoor survey.

## SURVEY AND INTERPOLATION – BUILDING D LEVEL 01

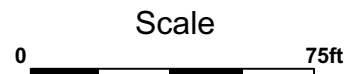
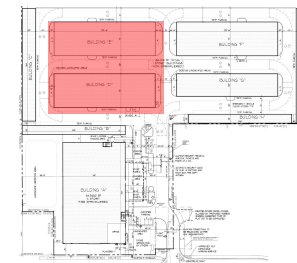
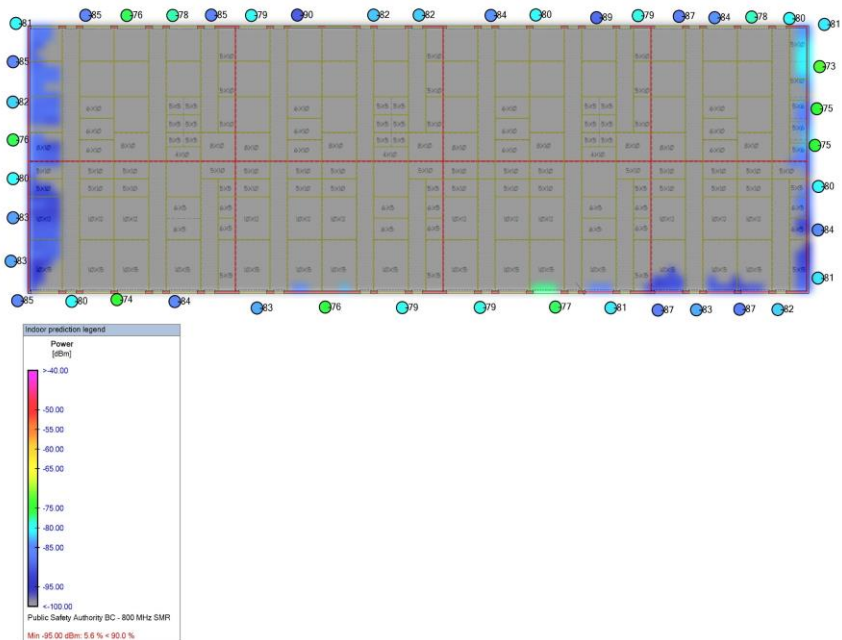

1521 SW 5th St  
Fort Lauderdale, FL 33312  
+1-954-607-4550  
FCC: 0021499876

**GM, CHIEF ENGINEER:**

Ric Caselli

**CLIENT:**

Perez Associates

**Top Shelf Storage**

**Project Architect:**

Frank Perez



**PROJECT LOCATION:**

2855 Martin Luther King  
Blvd., Pompano Beach Florida

**LATITUDE:**

26° 14'47.10"N

**LONGITUDE:**

80° 09'43.00"W

**ISSUE:**

11-01-2017

**AAC** Survey  
Page 10 of 11

PZ17-12000028  
8/3/2021

## SURVEY AND INTERPOLATION – BUILDING F LEVEL 01

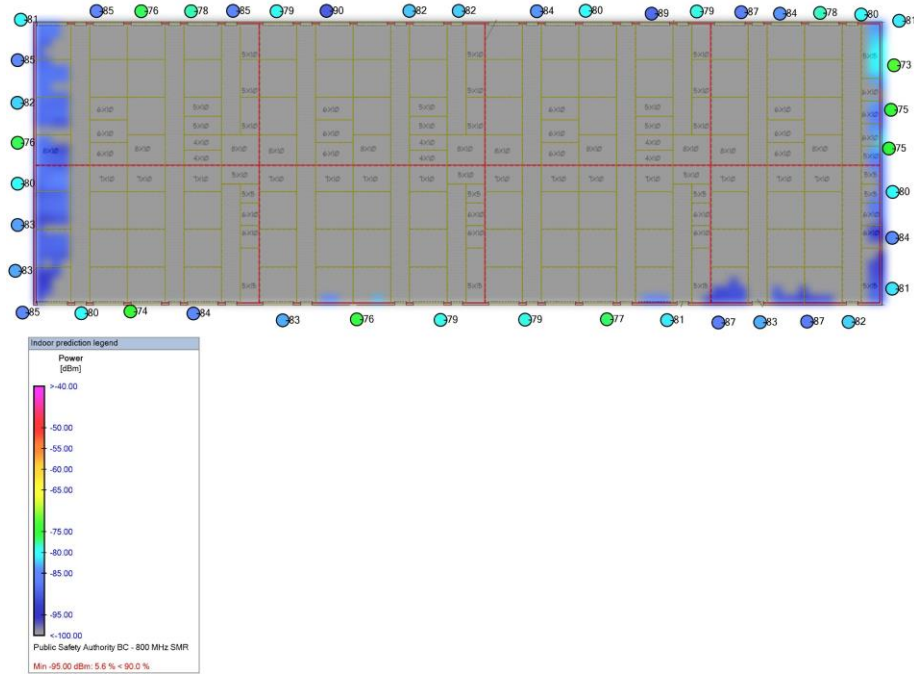

The interpolation indicates that the signal from outside penetrates some of the outdoor walls but there is no propagation at most corridors because of all metal in the building. Since this building has open corridors, it's up to the AHJ to require or not a system to achieve coverage.

These assumptions will need to be confirmed after the construction in a preliminary indoor survey.

## SURVEY AND INTERPOLATION – BUILDING G LEVEL 01

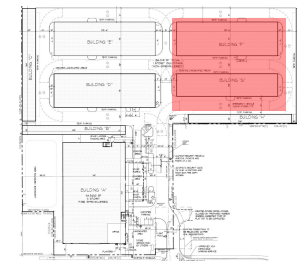
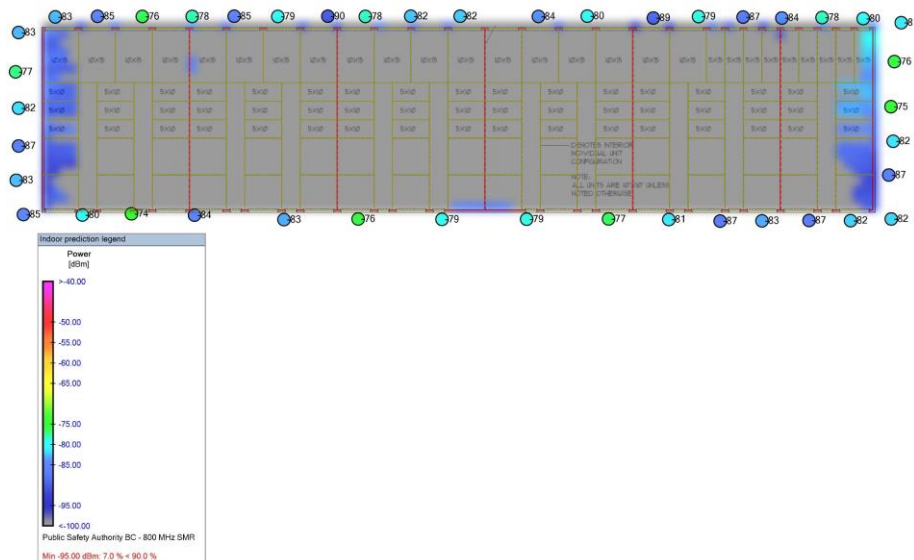

0 75ft



1521 SW 5th St  
Fort Lauderdale, FL 33312  
+1-954-607-4550  
FCC: 0021499876

**GM, CHIEF ENGINEER:**

Ric Caselli

**CLIENT:**

Perez Associates

**Top Shelf Storage**

**Project Architect:**

Frank Perez



**PROJECT LOCATION:**

2855 Martin Luther King Blvd., Pompano Beach Florida

**LATITUDE:**

26° 14'47.10"N

**LONGITUDE:**

80° 09'43.00"W

**ISSUE:**

11-01-2017

**AAC** Survey  
Page 11 of 11

PZ17-12000028  
8/3/2021